

BENOIT SYSTEMES



LIGHT ASSIST²

USER MANUAL



Follow us!

WWW.BENOITSYSTEMES.COM

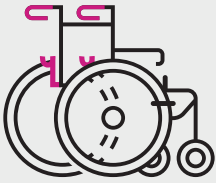

Your wheelchair has been fitted with **hook bars and hooks** that will allow you to set up your power add-on very quickly.
Brackets have been fitted on the wheelchair rear handles to put the Light Assist handles.

1 SETTING UP THE POWER ADD-ON

1. Put the brakes on the wheelchair to make the setting up easier.
2. Point the two clutch handles towards the rear (neutral position).
3. Hold the power add-on with its upper handle and place the axles on the hooks.
4. Make sure that the axles are positioned correctly.

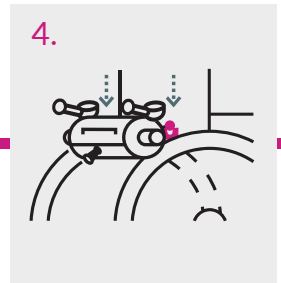
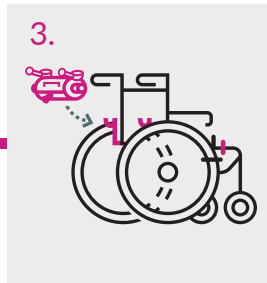
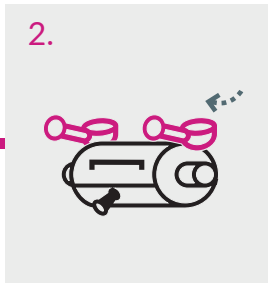

2 LOCKING THE HANDLES

1. Extend both telescopic handles to gain more force.
2. Engage both handles always beginning with the right-hand side.
3. Push back the telescopic handles.

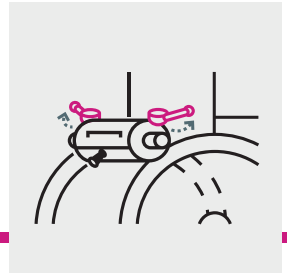

3 SETTING UP THE PUSH HANDLES

Two handles are supplied with the power add-on:

Forward/
Reverse switch

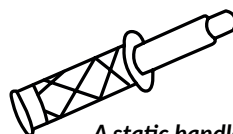
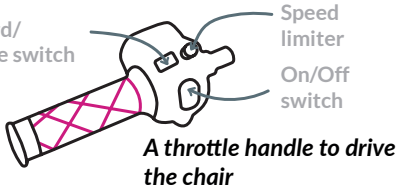

A static handle to make both handles the same length

Handles are locked with a pin at the left or right-hand side on the wheelchair rear handles.

4 SETTING UP THE BATTERY

1. Place the battery rack on the battery slider on the power add-on.
2. Firmly push the battery rack until you hear the connectors slot into each other.

1.

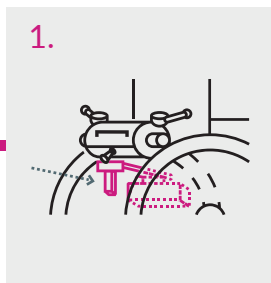

2.

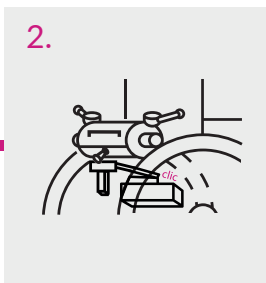

5 SETTING UP THE ANTI TIP

Insert the anti-tip into the rear handle on the power add-on (wheel bottom facing).

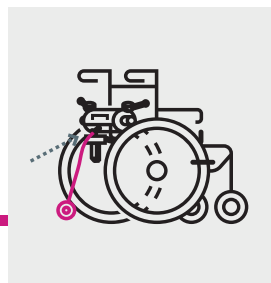

EXTRA FEATURE

Simple shift of the clutch handles is enough to disengage the power add-on and get your usual manual wheelchair back.

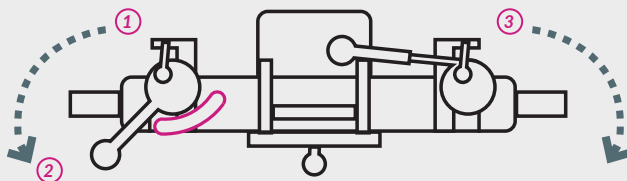

- ① Disengage the left handle and turn it slightly to the right.
- ② Wedge the handle in place on the **anti-swing stop**.
- ③ Disengage the right handle and place it all the way against the backrest.

INSTRUCTIONS FOR USE

In confined spaces, there are 2 solutions:

1. Disengage the power add-on and manually operate the wheelchair.
2. Use the speed limiter to freeze the power add-on at a very low speed and drive the wheelchair with the throttle handle.

As a pavement approaches:

Don't stop and try to lift the wheelchair!

Slowly approach the pavement, tilt the wheelchair (front castors on pavement) and go on.

6 REMOVING THE POWER ADD-ON

Put the brakes on the wheelchair to make the removal easier.

1. Keep the handles engaged.
2. Remove the anti-tip.
3. Unlock the battery with the help of the rack locking mechanism and pull it towards rear.
4. Remove the two Light Assist² handles.
5. Place the clutch handles in neutral position (pull the black button).

Lift the power add-on by grabbing the upper handle. Axles should come off the hooks.

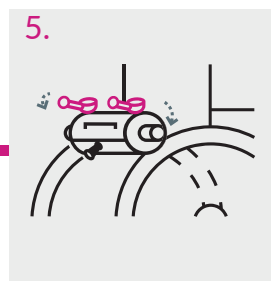
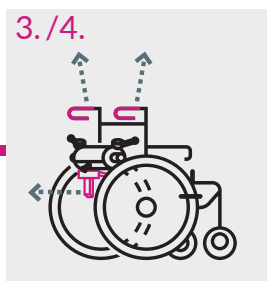
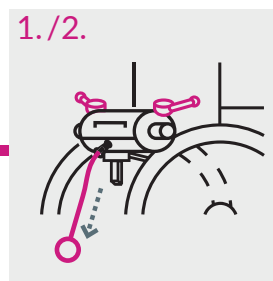

7 RECHARGING THE BATTERY

Connect both red connectors on the battery and charger together then plug the charger into the power supply.

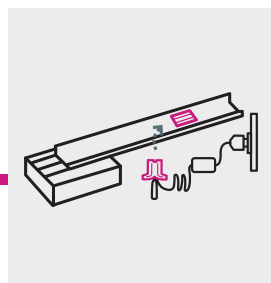

READ THE SERVICE MANUAL

for driving, security
and maintenance
instructions



📍 7 Rue du Pont, 21450 Billy Les Chanceaux FRANCE
☎ (+33) 3 80 96 51 25 | @ contact@benoitssystemes.com

WWW.BENOITSYSTEMES.COM